



BALL LIGHT
SMALL WALL BRACKET FLEX, 2008

Polished Brass
 2m standard flex length, bespoke length by order.



OVERALL DIMENSIONS

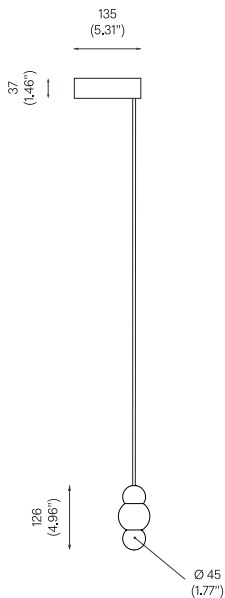

BACKPLATE DIMENSIONS

Mounting screws not included.
 6mm countersunk screw recommended.

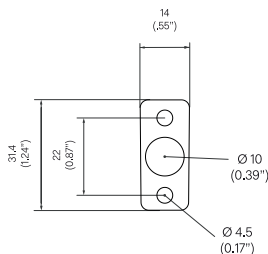

STANDARD MATERIAL/FINISH

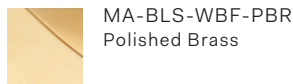

CUSTOM FINISHES

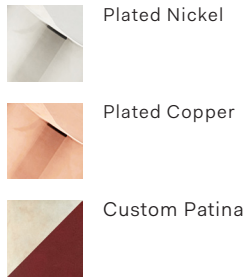

BULB SPECIFICATIONS

Input voltage: 120V / 240V
 Maximum wattage: 5W
 120V / 240V dimmable LED triac
 Product weight: 2kg
 IP20

Supplied with 2000mm long flex.

120V version supplied with paintable junction box cover.

CLEANING INSTRUCTIONS

Before cleaning, lighting fixtures must be turned off and unplugged from mains electricity. Whilst cleaning please take care and use the gloves provided.

Polished Brass: As the item is unlacquered it will naturally oxidise and darken. Upon touching the items without gloves, fingerprints are likely to occur and leave marks. Use a good quality brass cleaning liquid and follow the product instructions using the extra soft dust cloth. Do not apply pressure on persistent marks. Remove them using repeated gentle motions and by reapplying the brass cleaning liquid.

Plated Finish: Use a lightly damp soft dust cloth and gently go over marks until clean. Dry it afterwards with a soft dust cloth.

Patinated Finish: Use a dry soft dust cloth and gently go over marks until clean. The brass patina is achieved through an artisanal technique of applying pigments by hand during a hot patination process. Through this alchemic process, the brass is transformed whilst retaining the material's inherent qualities. It will mature and change overtime. The manner and speed in which it will change will depend on the environment, handling and the level and frequency of maintenance. Verdigris can also appear when the copper in the brass begins to oxidise.

Opaline Glass: Remove the opaline glass from the product. Using a lightly damp cloth, clean only the outside of the sphere. Only put the glass sphere back on the product once it is fully dry.



BALL LIGHT
LARGE WALL BRACKET FLEX, 2008

Polished Brass.
 2m standard flex length, bespoke length by order.



OVERALL DIMENSIONS

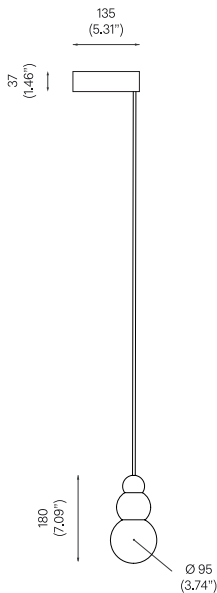

BACKPLATE DIMENSIONS

Mounting screws not included.
 6mm countersunk screw recommended.

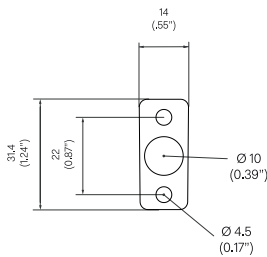

STANDARD MATERIAL/FINISH

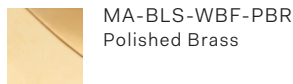

CUSTOM FINISHES

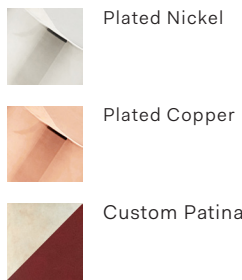

BULB SPECIFICATIONS

Input voltage: 120V / 240V
 Maximum wattage: 20W
 120V / 240V dimmable LED triac
 Product weight: 3kg
 IP20

Supplied with 2000mm long flex.

120V version supplied with paintable junction box cover.

CLEANING INSTRUCTIONS

Before cleaning, lighting fixtures must be turned off and unplugged from mains electricity. Whilst cleaning please take care and use the gloves provided.

Polished Brass: As the item is unlacquered it will naturally oxidise and darken. Upon touching the items without gloves, fingerprints are likely to occur and leave marks. Use a good quality brass cleaning liquid and follow the product instructions using the extra soft dust cloth. Do not apply pressure on persistent marks. Remove them using repeated gentle motions and by reapplying the brass cleaning liquid.

Plated Finish: Use a lightly damp soft dust cloth and gently go over marks until clean. Dry it afterwards with a soft dust cloth.

Patinated Finish: Use a dry soft dust cloth and gently go over marks until clean. The brass patina is achieved through an artisanal technique of applying pigments by hand during a hot patination process. Through this alchemic process, the brass is transformed whilst retaining the material's inherent qualities. It will mature and change overtime. The manner and speed in which it will change will depend on the environment, handling and the level and frequency of maintenance. Verdigris can also appear when the copper in the brass begins to oxidise.

Opaline Glass: Remove the opaline glass from the product. Using a lightly damp cloth, clean only the outside of the sphere. Only put the glass sphere back on the product once it is fully dry.



BALL LIGHT
SMALL WALL BRACKET PENDANT ROD, 2008

Polished Brass.
 Pendant rod length to order.



OVERALL DIMENSIONS

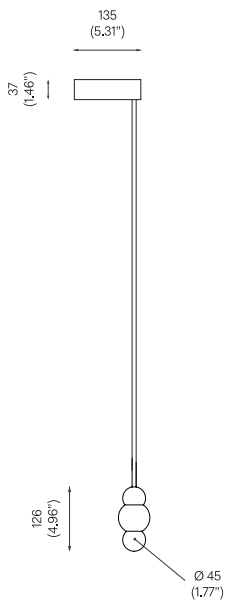

BACKPLATE DIMENSIONS

Mounting screws not included.
 6mm countersunk screw recommended.

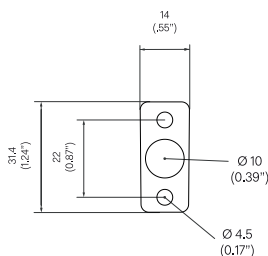

STANDARD MATERIAL/FINISH



CUSTOM FINISHES

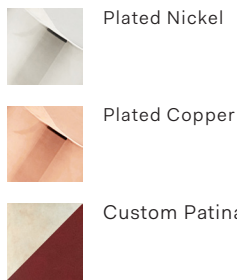

BULB SPECIFICATIONS

Input voltage: 120V / 240V
 Maximum wattage: 5W
 120V / 240V dimmable LED triac
 Product weight: 2kg
 IP20

Please supply required drop length of fixture, measured from the top to the bottom of the fitting at time of order.

Minimum total drop 180mm.
 Maximum total drop 2100mm.

Please allow 25mm tolerance of drop length.

120V version supplied with paintable junction box cover.

CLEANING INSTRUCTIONS

Before cleaning, lighting fixtures must be turned off and unplugged from mains electricity. Whilst cleaning please take care and use the gloves provided.

Polished Brass: As the item is unlacquered it will naturally oxidise and darken. Upon touching the items without gloves, fingerprints are likely to occur and leave marks. Use a good quality brass cleaning liquid and follow the product instructions using the extra soft dust cloth. Do not apply pressure on persistent marks. Remove them using repeated gentle motions and by reapplying the brass cleaning liquid.

Plated Finish: Use a lightly damp soft dust cloth and gently go over marks until clean. Dry it afterwards with a soft dust cloth.

Patinated Finish: Use a dry soft dust cloth and gently go over marks until clean. The brass patina is achieved through an artisanal technique of applying pigments by hand during a hot patination process. Through this alchemic process, the brass is transformed whilst retaining the material's inherent qualities. It will mature and change overtime. The manner and speed in which it will change will depend on the environment, handling and the level and frequency of maintenance. Verdigris can also appear when the copper in the brass begins to oxidise.

Opaline Glass: Remove the opaline glass from the product. Using a lightly damp cloth, clean only the outside of the sphere. Only put the glass sphere back on the product once it is fully dry.



BALL LIGHT
LARGE WALL BRACKET PENDANT ROD, 2008

Polished Brass.
 Pendant rod length to order.



OVERALL DIMENSIONS

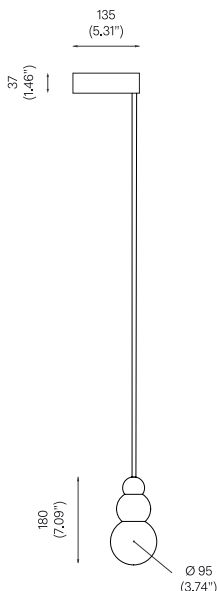

BACKPLATE DIMENSIONS

Mounting screws not included.
 6mm countersunk screw recommended.

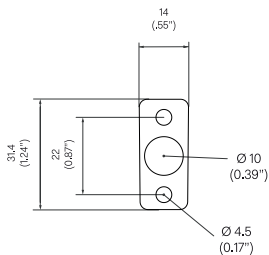

STANDARD MATERIAL/FINISH



CUSTOM FINISHES

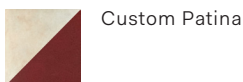
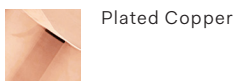
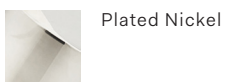

BULB SPECIFICATIONS

Input voltage: 120V / 240V
 Maximum wattage: 20W
 120V / 240V dimmable LED triac
 Product weight: 3kg
 IP20

Please supply required drop length of fixture, measured from the top to the bottom of the fitting at time of order.

Minimum total drop 220mm
 Maximum total drop 2135mm

Please allow 25mm tolerance of drop length.

120V version supplied with paintable junction box cover.

CLEANING INSTRUCTIONS

Before cleaning, lighting fixtures must be turned off and unplugged from mains electricity. Whilst cleaning please take care and use the gloves provided.

Polished Brass: As the item is unlacquered it will naturally oxidise and darken. Upon touching the items without gloves, fingerprints are likely to occur and leave marks. Use a good quality brass cleaning liquid and follow the product instructions using the extra soft dust cloth. Do not apply pressure on persistent marks. Remove them using repeated gentle motions and by reapplying the brass cleaning liquid.

Plated Finish: Use a lightly damp soft dust cloth and gently go over marks until clean. Dry it afterwards with a soft dust cloth.

Patinated Finish: Use a dry soft dust cloth and gently go over marks until clean. The brass patina is achieved through an artisanal technique of applying pigments by hand during a hot patination process. Through this alchemic process, the brass is transformed whilst retaining the material's inherent qualities. It will mature and change overtime. The manner and speed in which it will change will depend on the environment, handling and the level and frequency of maintenance. Verdigris can also appear when the copper in the brass begins to oxidise.

Opaline Glass: Remove the opaline glass from the product. Using a lightly damp cloth, clean only the outside of the sphere. Only put the glass sphere back on the product once it is fully dry.